

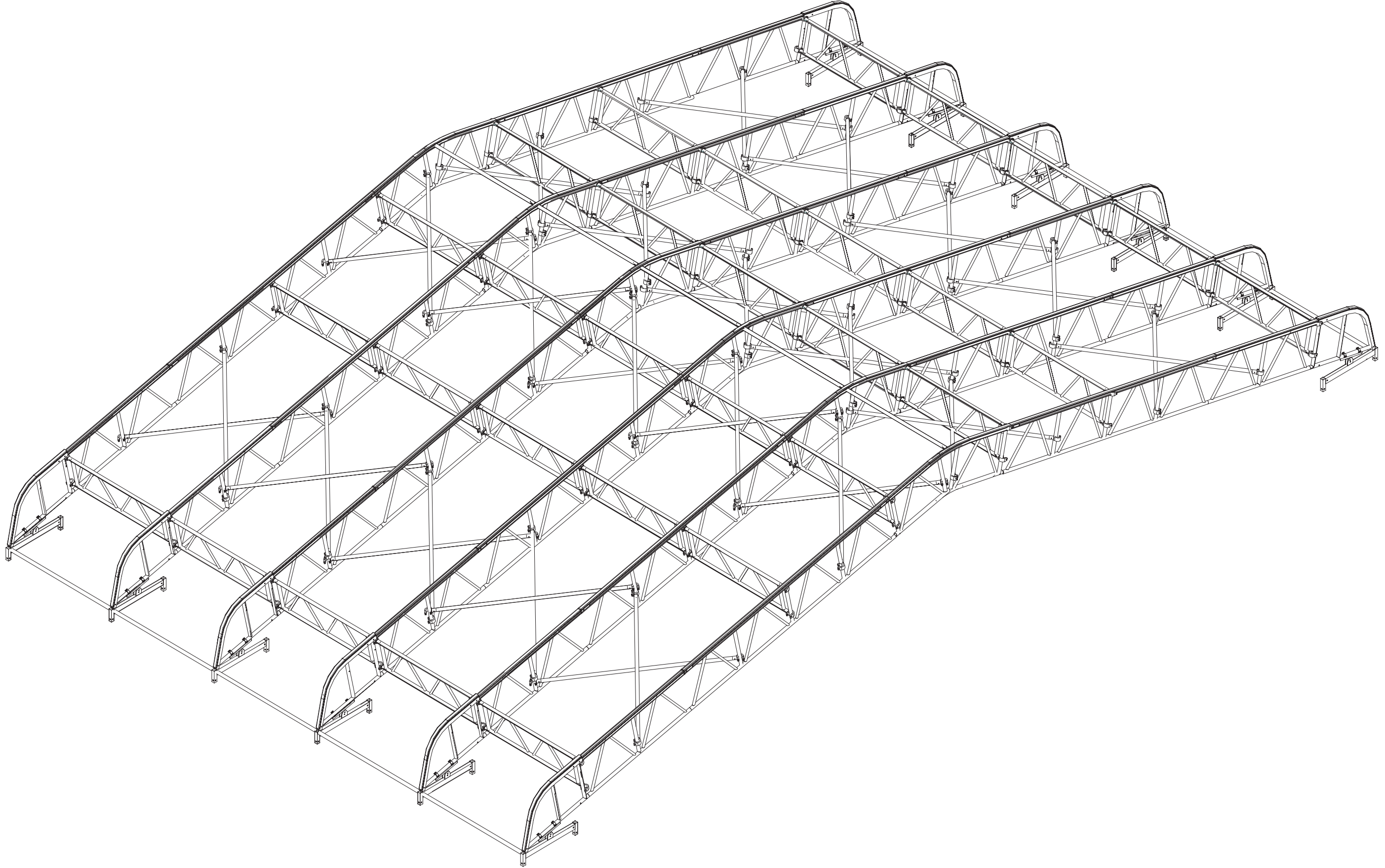

# ROOFTOP

*roof system*



---

## ▼ Size, load capacity\*, weight and covered area:

12x16 m - 80 kg/m<sup>2</sup> - 1670 kg - 192m<sup>2</sup>  
16x16 m - 60 kg/m<sup>2</sup> - 1870 kg - 256m<sup>2</sup>  
20x16 m - 40 kg/m<sup>2</sup> - 2650 kg - 320m<sup>2</sup>  
24x16 m - 40 kg/m<sup>2</sup> - 3030 kg - 384m<sup>2</sup>

---

## ▼ Slope: 21% (12°)

---

## ▼ Material: Aluminium EN AW 6082 T6

---

## ▼ Fireproof PVC sheet

\* Load capacity calculated with a wind thrust of 75 Km/h.

---

# CONDOR

[www.condorspa.com](http://www.condorspa.com)